

Sample Foundation Plan*

For an addition using a Pier and Beam Foundation

- Notes:
- (A) Give lumber dimension (example: "2 x 8")
 - (B) Give spacing layout (example: "16 in. on center")
 - (C) Give outside dimension
 - (D) Give spacing (no more than 8' on center)

* Foundation plans must be stamped and signed by a Texas certified engineer if the floor area exceeds 500 square feet.

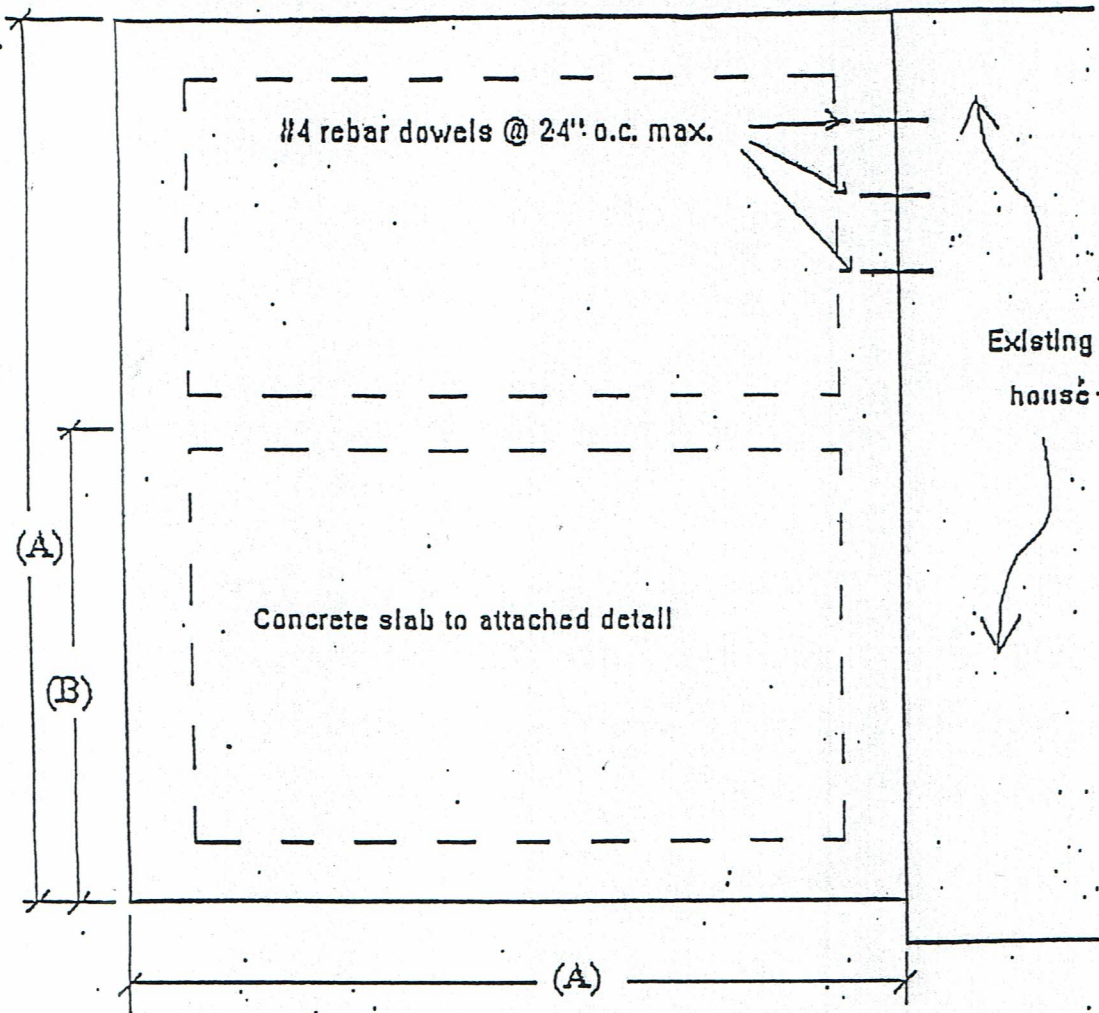

Sample Foundation Plan *

For an addition using a concrete slab foundation

Notes: (A) Give outside dimension

(B) Give distance to center of grade beam (no more than 20')

* Foundation plans must be stamped and signed by a Texas certified engineer if the floor area exceeds 500 square feet.

NOTES:

1. All Concrete must be 2500 p.s.i.
2. Bolts or straps mandatory only exterior piers.
3. Maximum pier spacing 8'-0" = 2x8 FL JOIST on centers.

FOR 6'-0" OK. 2x6 FL JOIST

RESIDENCES AND OTHER LIGHT FRAME STRUCTURES.

Pour Block and Pad together

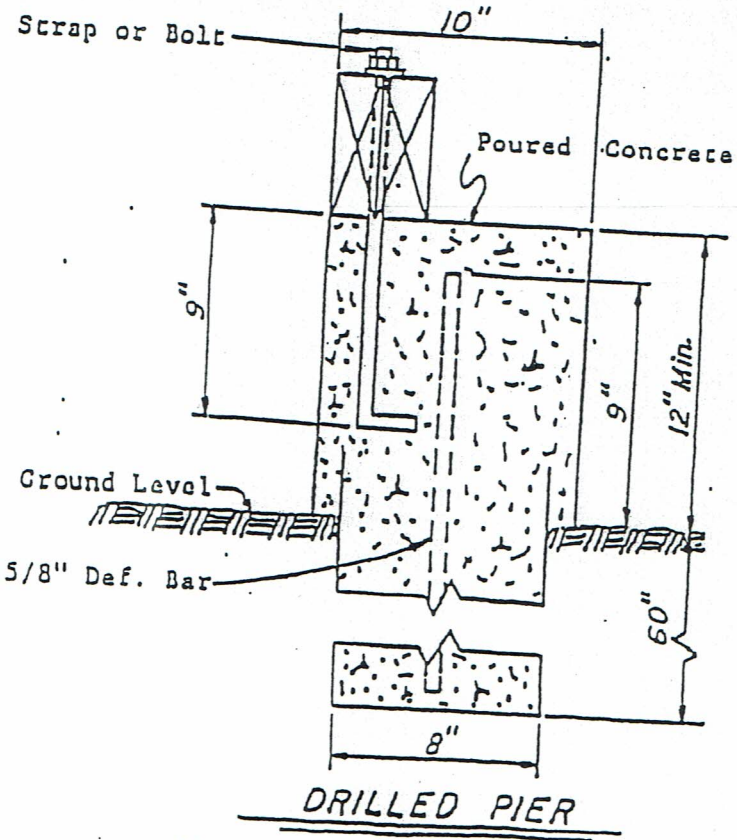
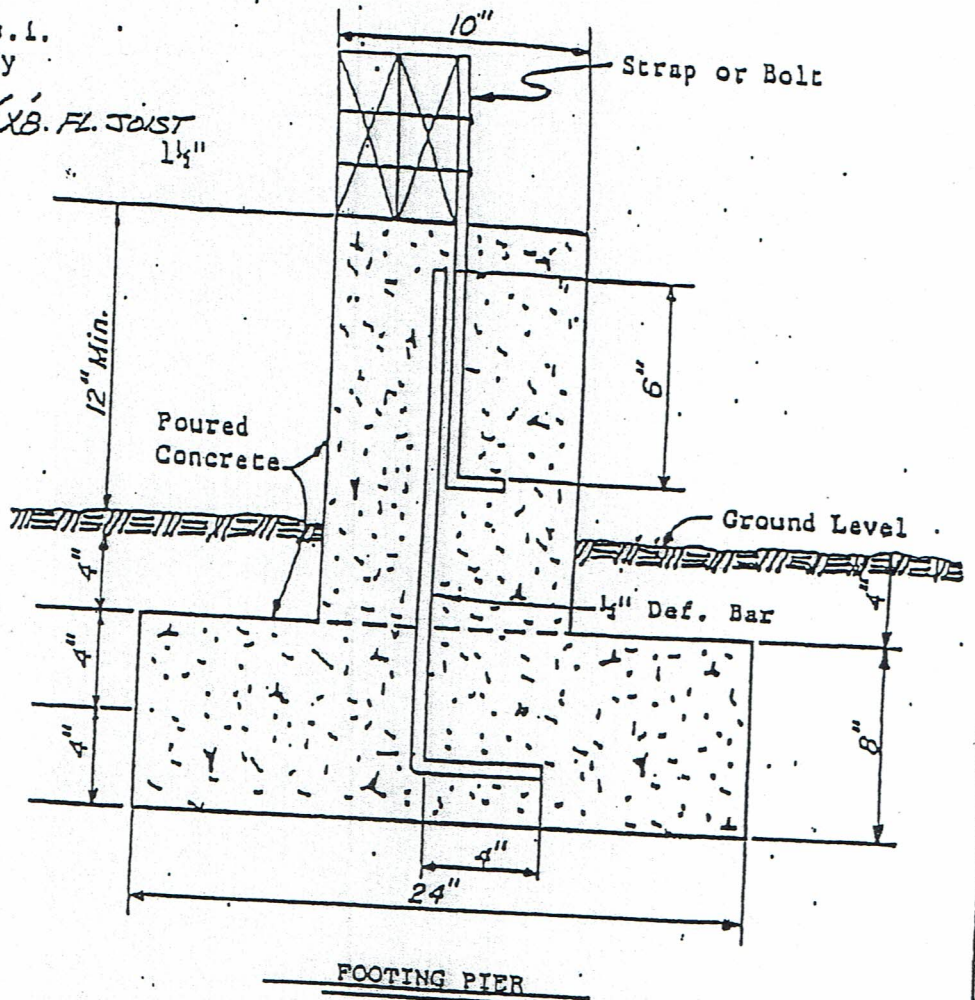

For One and Two Story Residences and Other Light Frame Structures

FIGURE 1312.3 (A)

TYPICAL PIER FOUNDATION DETAILS

BUILDING INSPECTION DEPARTMENT.